



**No pets, coolers, outside ‘food or beverages’ allowed.**

Food Prices

Cheeseburger - \$5.00 (10 tickets)

French Fries - \$3.50 (7 tickets)

Halupki - \$6 (12 tickets)

Halupki Dinner - \$8.50 (17 tickets)

• *includes Mashed Potato*

Haluski - \$3.50 (7 tickets)

Hamburger - \$4.50 (9 tickets)

Hot Dog - \$1.50 (3 tickets)

• *Add Sauerkraut or Chili Sauce \$2 (4 tickets)*

Pierogi (3) - \$4.50 (9 tickets)

Potato Pancake (2) - \$3.50 (7 tickets)

Sausage, Peppers & Onion \$6 (12 tickets)

Steak Sandwich - \$6.50 (13 tickets)

• *Add Cheese \$7.50 (15 tickets)*

Dessert Prices

Baked Goods – as marked

Cotton Candy - \$2.50 (5 tickets)

Funnel Cake - \$6 (12 tickets)

Snow Cone - \$2 (4 tickets)

Waffles & Ice Cream - \$5 (10 tickets)

Waffles, Ice Cream & Strawberries - \$6  
(12 tickets)

Beverage Prices Must be over 21 years of age to purchase

Beer 60 oz Pitcher - \$16 (34 tickets)

Leinenkugel 16 oz - \$5 (10 tickets)

Miller Lite 16 oz - \$5 (10 tickets)

“Adult Slushie” 61 oz - \$5 (10 tickets)

Birch Beer 16 oz - \$1.50 (3 tickets)

Birch Beer 64 oz Pitcher - \$6 (12 tickets)

Bottled Water 16 oz - \$1.50 (3 tickets)

Drink Can 12 oz - \$1.50 (3 tickets)

Coffee / Tea - \$1 (2 tickets)

Games Prices

➤ Kids

Inside Parish Hall

- Duck Pond (Friday) - \$1 (2 tickets)
- Bean Bag Toss (Friday) \$1 (2 tickets)
- Face Painting (small \$3 -6 tkt./large \$6 -12 tkt.)
- Bingo (Saturday) - \$2 cash
- Balloon Guy – Free, 1 per child

Outside

- Basketball Hoop (3) - \$1 (2 tickets)
- Bounce House \$3 (6 tickets)
- Candy Wheel \$1 (2 tickets)
- Football Toss (3) - \$1 (2 tickets)
- Petting Zoo (donation accepted)

➤ Adults

Outside

- 50/50 Raffle
- Dice Wheel
- Pull – Off Lottery
- Alcohol Basket Raffle
- Parish Raffle



Please visit us at: [sercc.org](http://sercc.org)

<https://www.facebook.com/people/St-Elizabeth-Parish-Festival>

# St Elizabeth Parish Festival

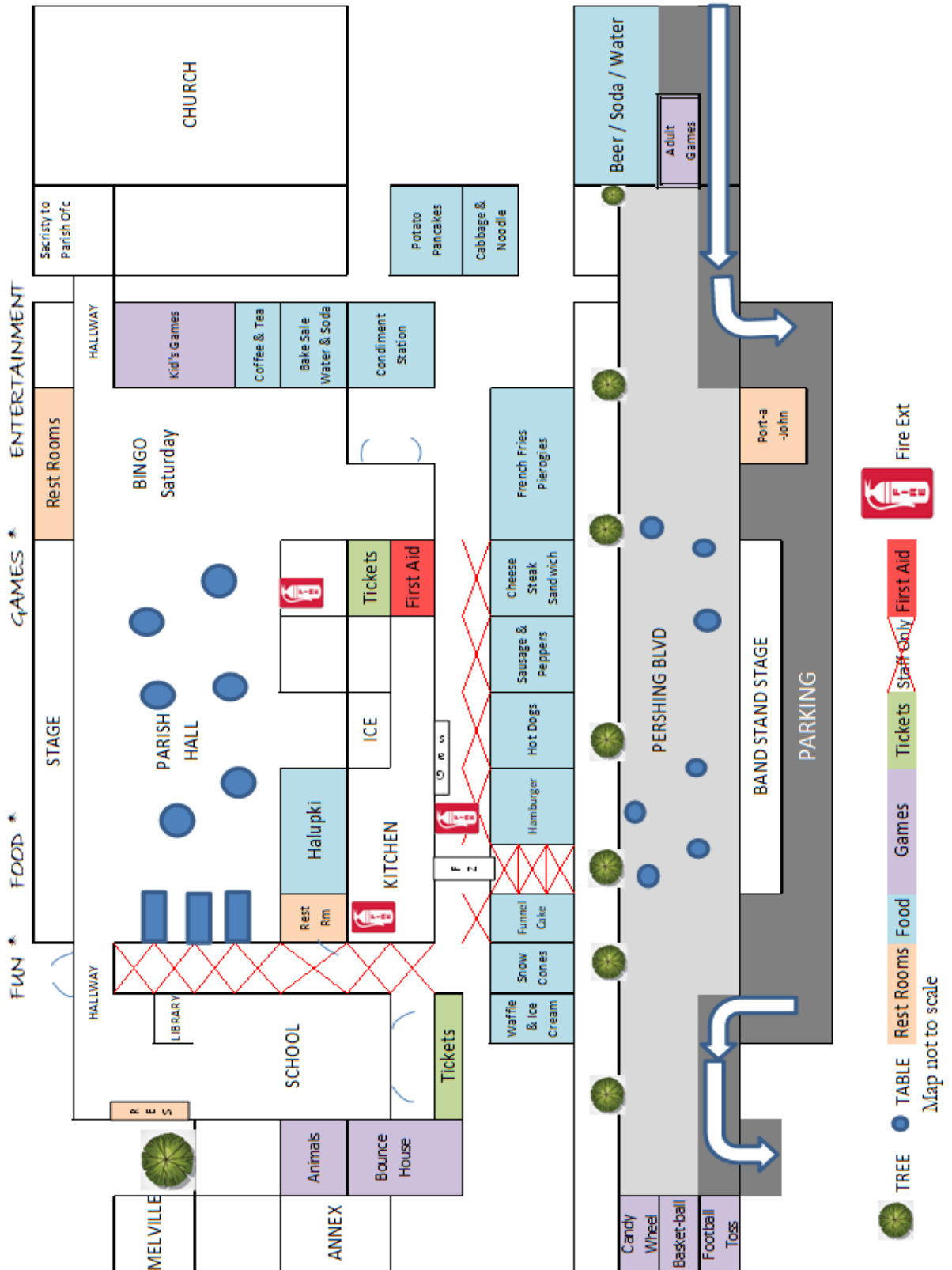

Please visit us at: [sercc.org](http://sercc.org)  
<https://www.facebook.com/people/St-Elizabeth-Parish-Festival>